

TRACK—CONTINUED

INCREASING TRACK TENSION

- 1 Drive vehicle onto hard level ground.
- 2 Drive vehicle slowly forward until hole through hub flange of trailing idler wheel is aligned with hole in eccentric spindle (1). Insert 10 in. (25.4 cm) of bar handle (2) (item 45, appx B) through hub flange and into eccentric spindle (1).
- 3 Using socket wrench (item 135, appx B), loosen self-locking nut (3) on eccentric spindle screw (4). Nuts are torqued (oiled threads and washer). Drive wedge (5) (item 120, appx B) into joint to relieve tension on eccentric spindle (1). Notify unit maintenance for torquing.

CAUTION

Bar handle must not travel below centerline of trailing idler arm.

- 4 Drive vehicle slowly forward to increase track tension.

NOTE

- | If proper tension has not been achieved by the time the bar handle reaches centerline of trailing idler arm, remove one track shoe. Reassemble track and adjust track to proper tension.
- | Make sure that track does not bunch up between road wheels during track tensioning.
- | Lubricate screws and nuts with oil (item 34, appx D) before installing.

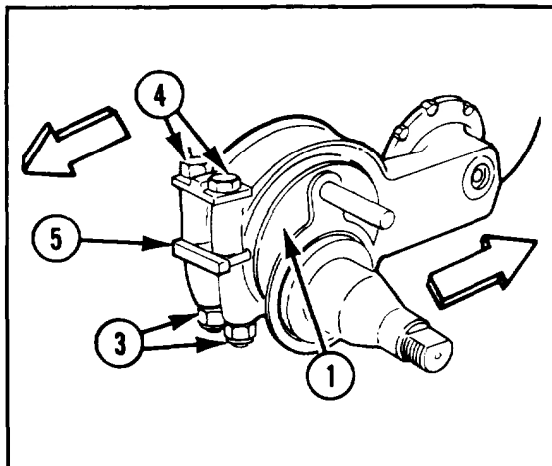
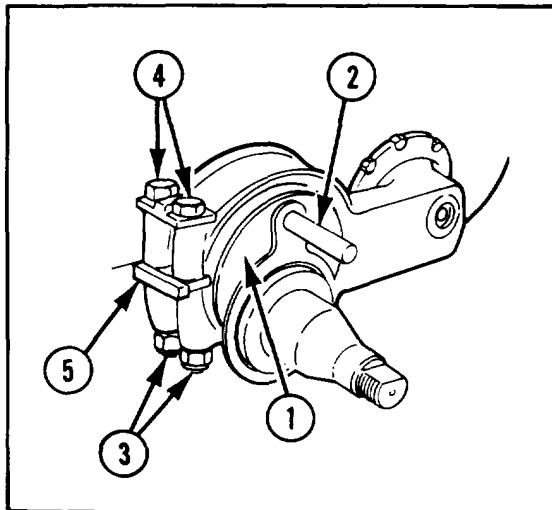

CAUTION

Ensure spindle arm clearance is correct. Refer to p 3-39.

- 5 Remove wedge (5) from eccentric spindle (1). Tighten eccentric spindle screws (4) and nuts (3) as tight as possible using socket wrench (item 135, appx B). As soon as possible have unit maintenance check and torque spindle nuts (3).

TRACK—CONTINUED

INSTALLING TRACK

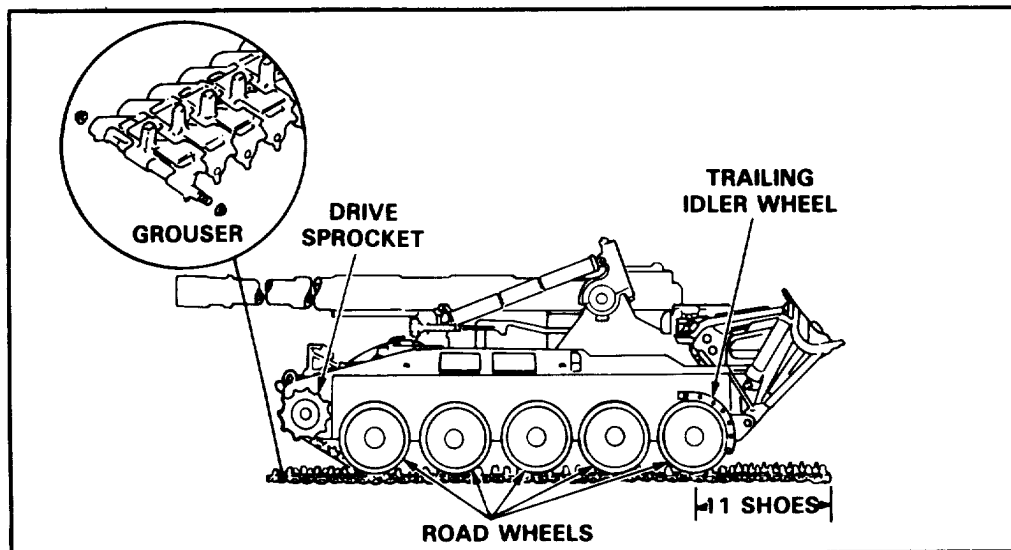

- 1 Lay track out in front of vehicle in a straight line, directly ahead of and touching the first road wheel. Position track on ground with shoe grousers facing forward.
- 2 Start engine and drive slowly onto track to a point where 11 track shoes extend past centerline of trailing idler wheel.
- 3 Stop engine; leave parking brake off.
- 4 Place drift pin (item 30, appx B) in track shoe pin hole on last shoe at rear of vehicle. Lift the end of track over trailing idler wheel.
- 5 Start engine and move vehicle forward slowly allowing track to rest on road wheels. Lift up on end of track, preventing end from getting caught between the road wheels. When track reaches drive sprocket, pry or lift track over sprocket.
- 6 Using drive sprocket, bring both ends of track together.
- 7 Install two track connecting fixtures (item 38, appx B) across track shoes to be connected and tighten equally until holes in ends of track are aligned. Connect shoes with track shoe link pin and install self-locking nut.
- 8 Tighten two nuts on track shoe link pin. Remove track connecting fixtures. As soon as possible, have unit maintenance tighten nuts.
- 9 Increase track tension. Refer to page 3-44.